

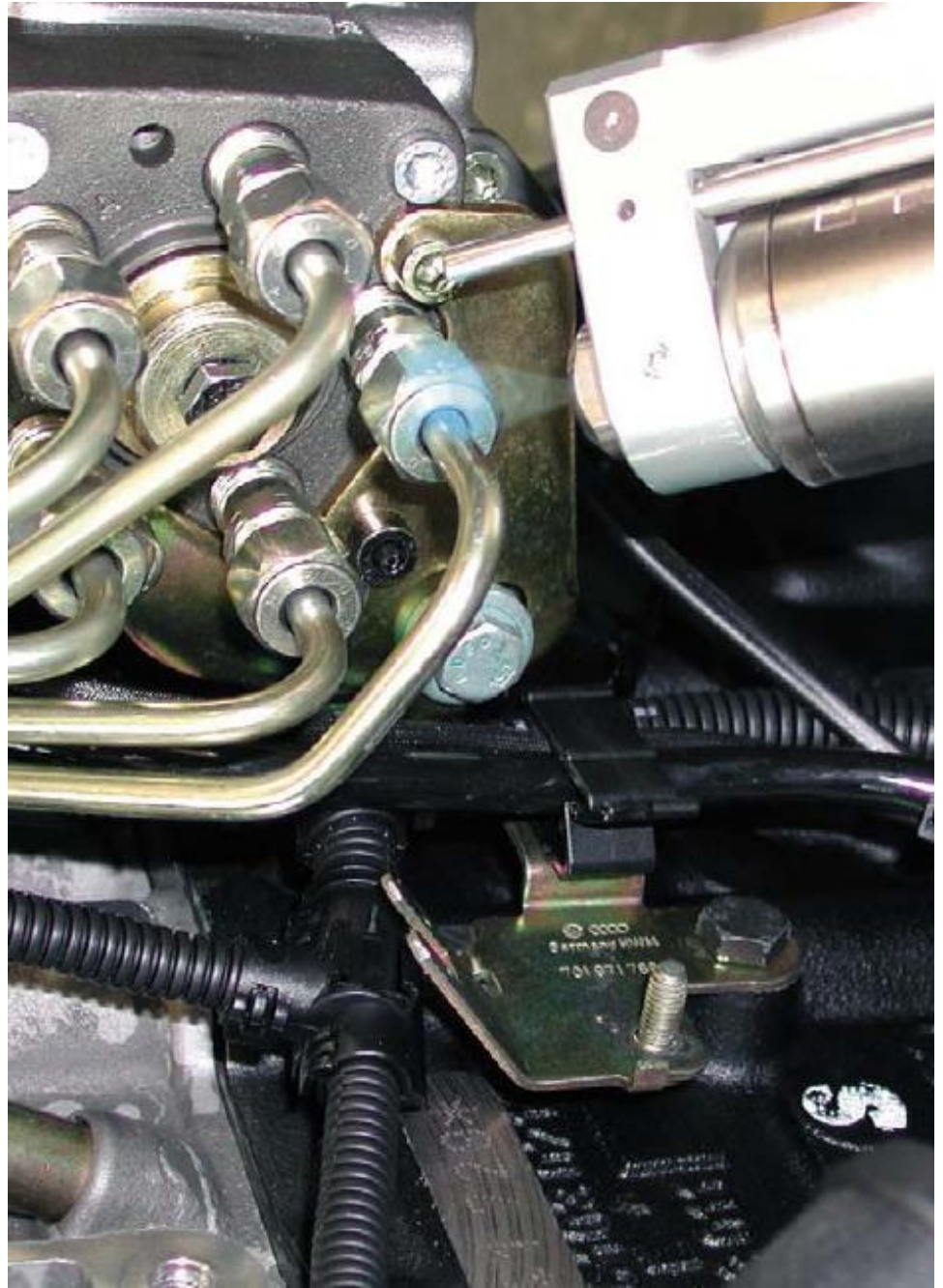

RHINO ASSEMBLY CORPORATION



Sicopoint 9000

The Professional Marking System
for Conspicuous Color Markings in Manufacturing and Quality Control.

5900 HARRIS TECHNOLOGY BLVD. – SUITE - T
Charlotte, North Carolina 28269

Toll free 888.727.7882/ Phone 704.395.2100/ Fax 704.395.2850
www.rhinoassembly.com

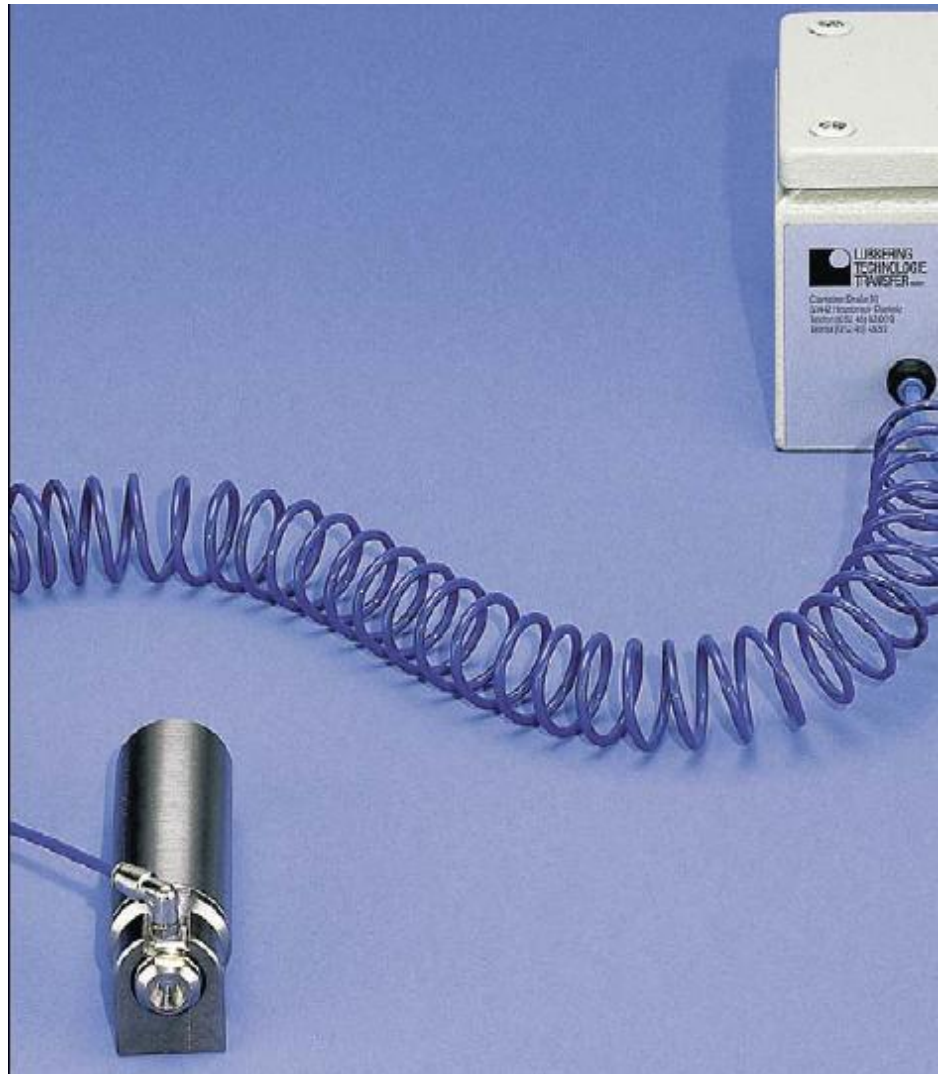

Sicopoint 9000

- The Sicopoint 9000 was developed to provide affordable, process controlled, problem-free color marking a reality
- Sicopoint 9000 is a rational system that can be used sensibly in many different manufacturing areas and in quality control.
- With low installation costs the system can be amortized quickly due to high application safety and minimal maintenance expenses.
- The disposable color cartridges can be changed in the blink of an eye, and the device is immediately ready for further use without additional maintenance steps required
- A variety of standard colors and even special colors are available.

Due to its clearly defined interfaces, the Sicopoint 9000 color marking system can be easily integrated into your existing manufacturing sequences. The Sicopoint 9000 actuating system is just as comfortable to use as the marking system itself. Sicopoint 9000 is easily connected to the Vario valve box. The valve box converts a signal from the process control system, whether potential free or 0-30 Volt, and sends the air pulse to the basic unit. The signal length is set using a potentiometer, which is used to control the desired marking size. Sicopoint 9000 now makes an optimum marking, point for point. No pollution of the workstation by liquid color; no maintenance work on dried spray nozzles, changing from one color to another within minutes.



Sicopoint 9000

Standard nozzle/extension:

- The Sicopoint 9000 basic unit can be alternatively equipped with the standard nozzle or an extension of up to 200mm.

Color cartridge:

- The color cartridges are stored vertically and face-down, as shown.
- The proper storage position is marked on the packaging.

Vario valve box:

- The Vario valve box consists of time-control electronics and a special 3/2 directional valve.
- The use of the Vario valve box guarantees consistent marking, thus resulting in a problem-free visual inspection.

Recommended installation variants

To guarantee optimum marking, Sicopoint 9000 should be installed with a distance of 15-25mm between the nozzle and the object being marked. In the process, please note that not all desired installation variants will lead to an optimum result. For this reason, we recommend installation only in the variants shown. In this way, Sicopoint 9000 can also be installed sensibly in extremely narrow areas.

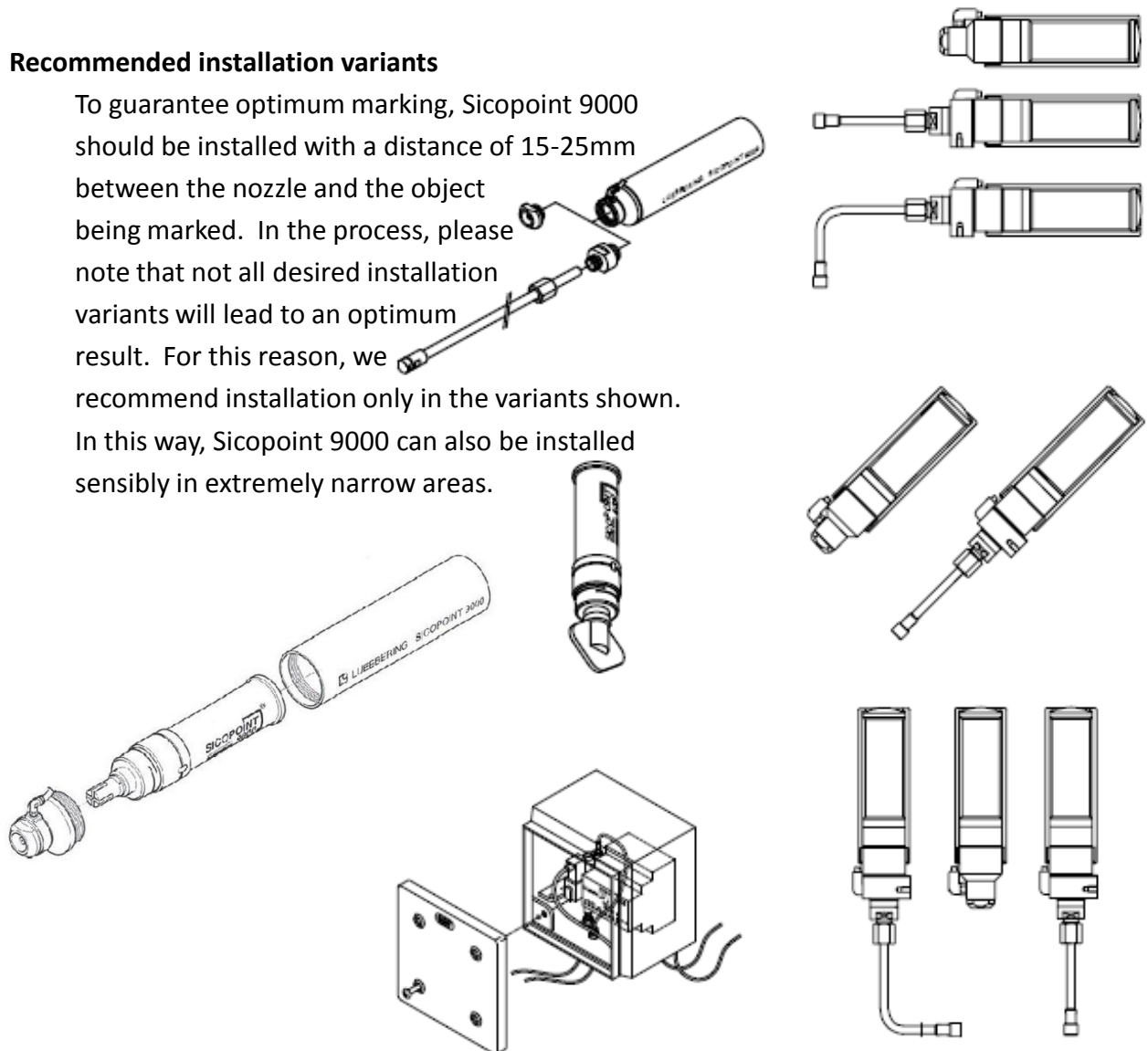

Basic Marking Assembly

Basic assembly including standard holders, protective sleeve and color cartridge

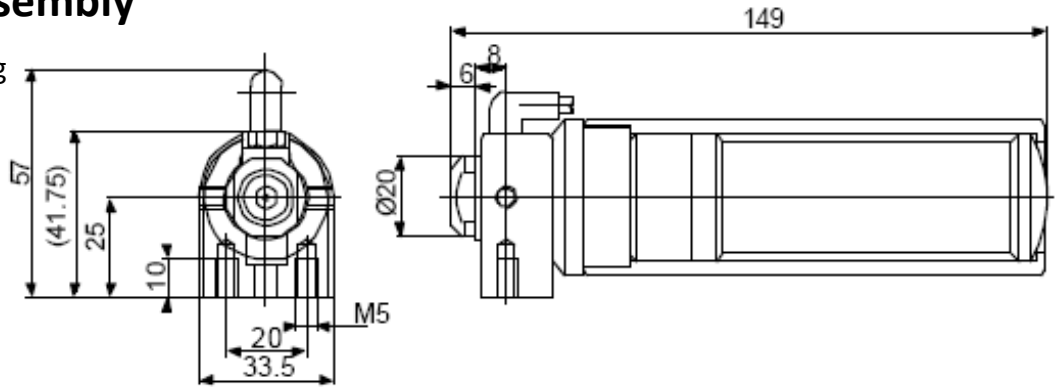

Basic Marking Assembly with Extension

Basic assembly as described above including 200 mm extension.

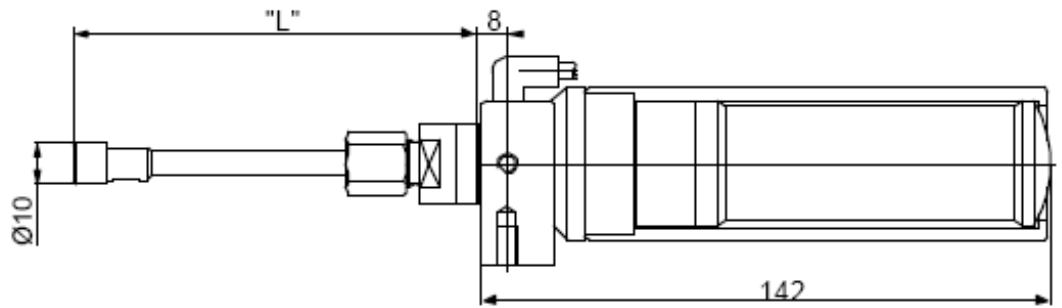

Vario Pulse Controller Mounting Dimensions

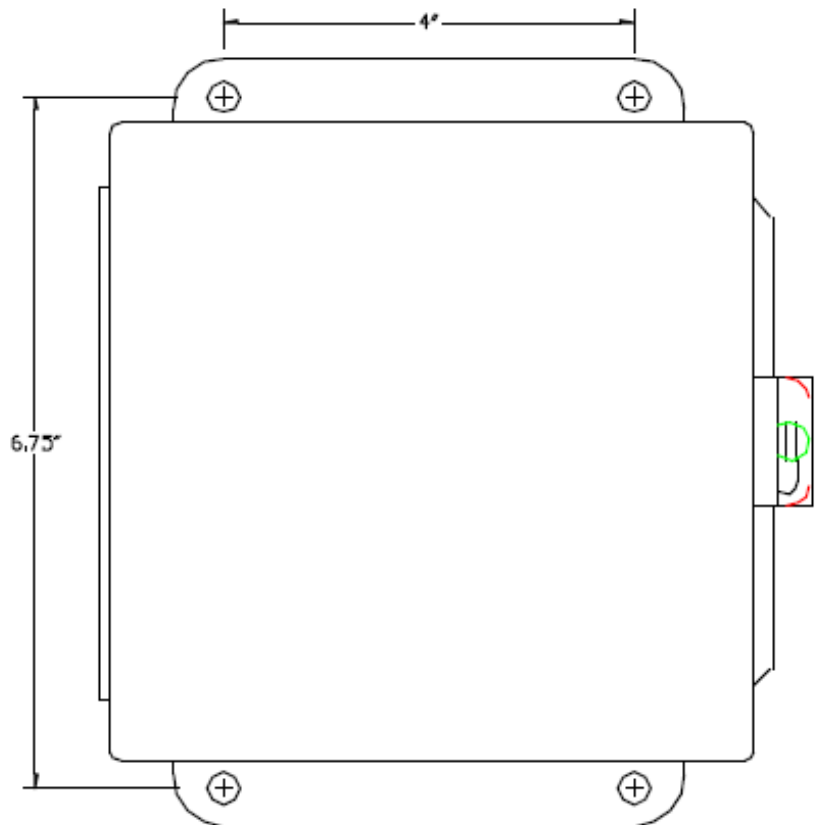

RHINO ASSEMBLY CORPORATION

5900 HARRIS TECHNOLOGY BLVD. – SUITE - T

Charlotte, North Carolina 28269

Toll free 888.727.7882/ Phone 704.395.2100/ Fax 704.395.2850

www.rhinoassembly.com